

**M54 to M6 Link Road**  
**TR010054**  
**Volume 2**  
**2.4 Works Plans**

Regulation 5(2)(j)

Planning Act 2008

Infrastructure Planning (Applications: Prescribed  
Forms and Procedure) Regulations 2009

January 2020

Infrastructure Planning

Planning Act 2008

**The Infrastructure Planning  
(Applications: Prescribed Forms and  
Procedure) Regulations 2009**

**M54 to M6 Link Road  
Development Consent Order 202[ ]**

---

**Works Plans**

---

|   |   |
|---|---|
| <b>Regulation Number</b>                      | Regulation 5(2)(j)                                    |
| <b>Planning Inspectorate Scheme Reference</b> | TR010054  |
| <b>Application Document Reference</b>         | 2.4   |
| <b>Author</b>                                 | M54 to M6 Link Road Project Team and Highways England |

| <b>Version</b> | <b>Date</b>  | <b>Status of Version</b> |
|----------------|--------------|--------------------------|
| P01            | January 2020 | DCO Application          |



## Schedule of Plans included in this Application Document

| Drawing Number                          | Drawing Title                                | Revision |
|---|--|----------|
| HE514465-ACM-DCO-M54_SW_PR_Z-DR-CH-1100 | WORK PLANS REGULATION 5(2)(J) KEY SHEET      | P03      |
| HE514465-ACM-DCO-Z1_SW_PR_Z-DR-CH-1101  | WORK PLANS REGULATION 5(2)(J) SHEET 1 OF 10  | P03      |
| HE514465-ACM-DCO-Z1_SW_PR_Z-DR-CH-1102  | WORK PLANS REGULATION 5(2)(J) SHEET 2 OF 10  | P03      |
| HE514465-ACM-DCO-Z1_SW_PR_Z-DR-CH-1103  | WORK PLANS REGULATION 5(2)(J) SHEET 3 OF 10  | P03      |
| HE514465-ACM-DCO-Z1_SW_PR_Z-DR-CH-1104  | WORK PLANS REGULATION 5(2)(J) SHEET 4 OF 10  | P03      |
| HE514465-ACM-DCO-Z2_SW_PR_Z-DR-CH-1105  | WORK PLANS REGULATION 5(2)(J) SHEET 5 OF 10  | P03      |
| HE514465-ACM-DCO-Z3_SW_PR_Z-DR-CH-1106  | WORK PLANS REGULATION 5(2)(J) SHEET 6 OF 10  | P03      |
| HE514465-ACM-DCO-Z3_SW_PR_Z-DR-CH-1107  | WORK PLANS REGULATION 5(2)(J) SHEET 7 OF 10  | P03      |
| HE514465-ACM-DCO-Z3_SW_PR_Z-DR-CH-1108  | WORK PLANS REGULATION 5(2)(J) SHEET 8 OF 10  | P03      |
| HE514465-ACM-DCO-Z3_SW_PR_Z-DR-CH-1109  | WORK PLANS REGULATION 5(2)(J) SHEET 9 OF 10  | P03      |
| HE514465-ACM-DCO-Z3_SW_PR_Z-DR-CH-1110  | WORK PLANS REGULATION 5(2)(J) SHEET 10 OF 10 | P04      |





- NOTES**
1. THIS DRAWING IS TO BE READ IN CONJUNCTION WITH ALL OTHER RELEVANT DOCUMENTATION.
  2. DO NOT SCALE FROM THIS DRAWING. USE ONLY PRINTED DIMENSIONS.
  3. ALL DIMENSIONS IN MILLIMETRES. ALL CHAINAGES, LEVELS AND COORDINATES ARE IN METRES UNLESS DEFINED OTHERWISE.
  4. THIS DRAWING IS TO BE READ IN CONJUNCTION WITH THE PROJECT HEALTH & SAFETY FILE FOR ANY IDENTIFIED POTENTIAL RISKS.
  5. THE WORKS ARE SHOWN ILLUSTRATIVELY ONLY AND ARE SUBJECT TO CHANGE THROUGH DETAILED DESIGN IN ACCORDANCE WITH THE TERMS OF THE DEVELOPMENT CONSENT ORDER.

**KEY**

|  |   |
|--|---|
|  | LIMITS OF LAND TO BE ACQUIRED OR USED PERMANENTLY OR TEMPORARILY (THE ORDER LIMITS) |
|  | LAND NOT INCLUDED WITHIN THE ORDER LIMITS   |

FOR CONTINUATION SEE INSET A

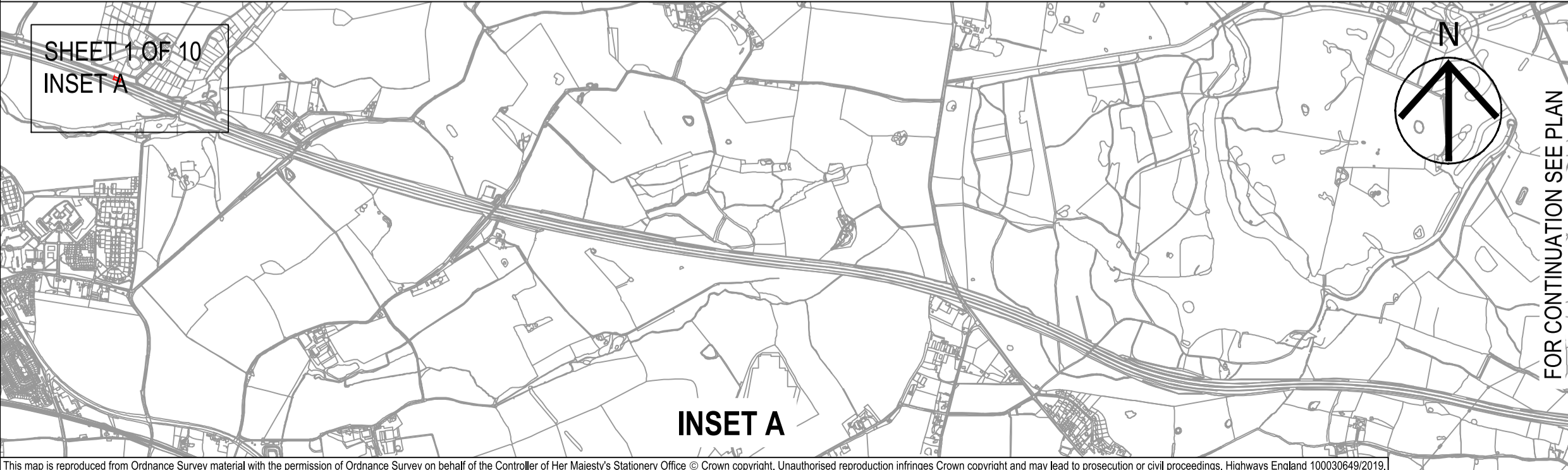
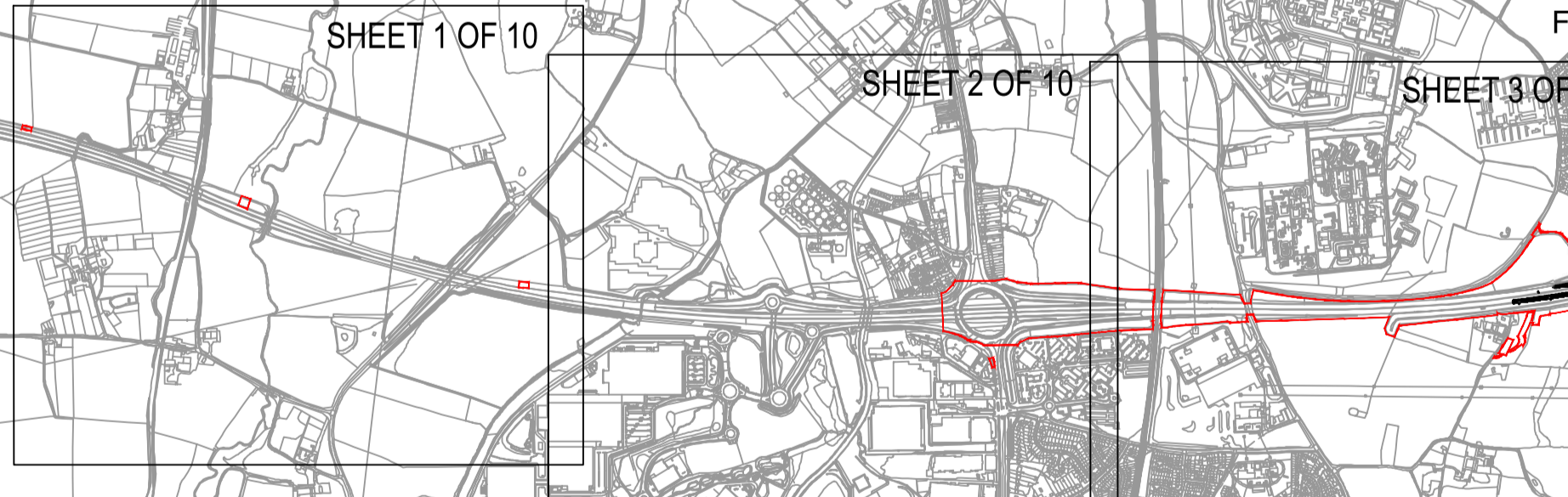

| Revision Details             | By | Check | Date     | Suffix |
|------------------------------|----|-------|----------|--------|
| First Issue                  | MW | RR    | 18/11/19 | P01    |
| DCO Submission               | JP | RR    | 06/12/19 | P02    |
| DCO Submission Minor Changes | JP | RR    | 28/01/20 | P03    |

**DCO APPLICATION**

Client  
Highways England  
Floor 5  
Two Colmore Square  
38 Colmore Circus  
Birmingham  
B4 6BN

Development Consent Order Number  
**TR010054**

Project Title  
**M54 to M6 Link Road**

Development Consent Order Drawing Number  
**TR010054/APP/2.4**

**WORK PLANS  
REGULATION 5(2)(J)  
KEY SHEET**

| Designed | Drawn | Checked | Approved | Date     |
|----------|-------|---------|----------|----------|
| MW       | JP    | AM      | RR       | 28/01/20 |

Internal Project No. 60536736  
Scale @ A1 1:20000H/1:20000V  
Suitability S8  
Zone Development Consent Order

THIS DOCUMENT HAS BEEN PREPARED PURSUANT TO AND SUBJECT TO THE TERMS OF AECOM'S APPOINTMENT BY ITS CLIENT. AECOM ACCEPTS NO LIABILITY FOR ANY USE OF THIS DOCUMENT OTHER THAN BY ITS ORIGINAL CLIENT OR FOLLOWING AECOM'S EXPRESS AGREEMENT TO SUCH USE, AND ONLY FOR THE PURPOSES FOR WHICH IT WAS PREPARED AND PROVIDED.

|  |                            |                             |                      |
|--|----------------------------|-----------------------------|----------------------|
| Drawing Number<br>Highways England PIN<br><b>HE514465 -ACM</b> | Originator<br><b>-DCO-</b> | Volume<br><b>DR-CH-1100</b> | Rev<br><b>P03</b>    |
| Location<br><b>M54_SW_PR_Z</b>                                 | I Type<br><b>I</b>         | I Role<br><b>I</b>          | I Number<br><b>I</b> |

**PLAN**



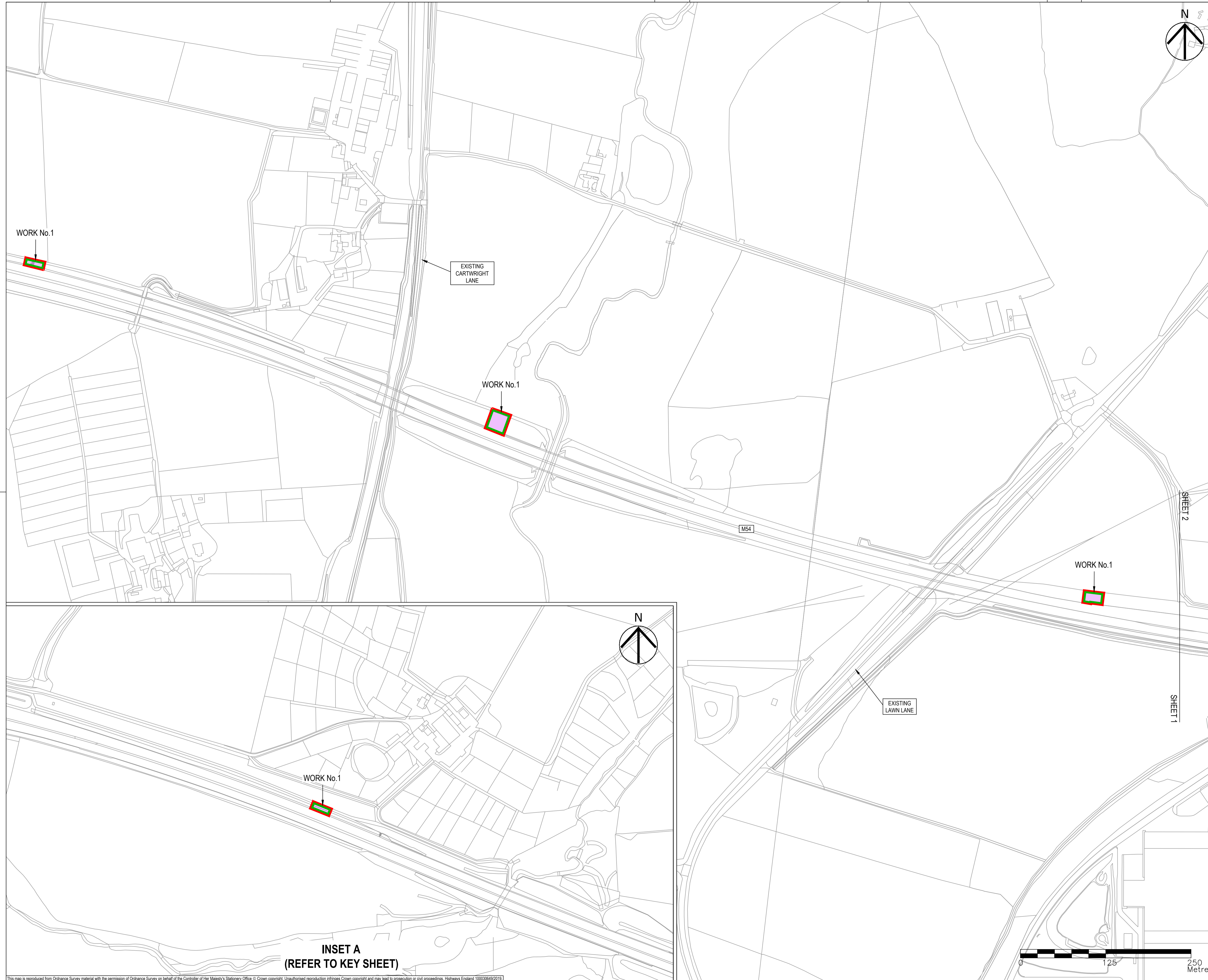

- NOTES**
1. THIS DRAWING IS TO BE READ IN CONJUNCTION WITH ALL OTHER RELEVANT DOCUMENTATION.
  2. DO NOT SCALE FROM THIS DRAWING, USE ONLY PRINTED DIMENSIONS.
  3. ALL DIMENSIONS IN MILLIMETRES, ALL CHAINAGES, LEVELS AND COORDINATES ARE IN METRES UNLESS DEFINED OTHERWISE.
  4. THIS DRAWING IS TO BE READ IN CONJUNCTION WITH THE PROJECT HEALTH & SAFETY FILE FOR ANY IDENTIFIED POTENTIAL RISKS.
  5. THE WORKS ARE SHOWN ILLUSTRATIVELY ONLY AND ARE SUBJECT TO CHANGE THROUGH DETAILED DESIGN IN ACCORDANCE WITH THE TERMS OF THE DEVELOPMENT CONSENT ORDER.

- KEY**
- LIMITS OF LAND TO BE ACQUIRED OR USED PERMANENTLY OR TEMPORARILY (THE ORDER LIMITS)
  - LAND NOT INCLUDED WITHIN THE ORDER LIMITS
  - COMMENCEMENT OF LINEAR WORKS (APPROX.)
  - TERMINATION OF LINEAR WORKS (APPROX.)
  - HIGHWAY WORK CENTRELINE (APPROX.)
  - NON-LINEAR WORKS BOUNDARY
  - HIGHWAY WORK LIMIT OF DEVIATION
  - ENVIRONMENTAL MITIGATION AREA
  - SITE COMPOUND
  - BORROW PIT LIMITS OF DEVIATION
  - HIGHWAY DRAINAGE ATTENUATION POND
  - UTILITY DIVERSION CENTRELINE (APPROX.)
  - UTILITY DIVERSION LIMITS OF DEVIATION
  - PROPOSED GANTRY LIMIT OF DEVIATION
  - EXISTING GANTRY TO BE ALTERED
  - PROPOSED STRUCTURE
  - TYPE 1 ALTERATION OF PORTAL GANTRY
  - TYPE 2 ALTERATION OF CANTILEVER GANTRY
  - TYPE 3 NEW PORTAL GANTRY
  - TYPE 4 NEW CANTILEVER GANTRY

| Revision                     | By | Check | Date     | Suffix |
|------------------------------|----|-------|----------|--------|
| First Issue                  | MW | RR    | 18/11/19 | P01    |
| DCO Submission               | JP | RR    | 06/12/19 | P02    |
| DCO Submission Minor Changes | JP | RR    | 28/01/20 | P03    |

**Purpose of issue**  
DCO APPLICATION

**Client**  
Highways England  
Floor 5  
Two Colonnade Square  
38 Colonnade Circus  
Birmingham  
B4 6BN

**Development Consent Order Number**  
TR010054

**Project Title**  
M54 to M6 Link Road



**Development Consent Order Drawing Number**  
TR010054/APP/2.4

**Drawing Title**  
WORK PLANS  
REGULATION 5(2)(J)  
SHEET 1 OF 10

| Designed | Drawn | Checked | Approved | Date     |
|----------|-------|---------|----------|----------|
| MW       | JP    | AM      | RR       | 28/01/20 |

Internal Project No. 60536736  
Suitability S8  
Scale @ A1 1:2500H/1:2500V  
Zone Development Consent Order

THIS DOCUMENT HAS BEEN PREPARED PURSUANT TO AND SUBJECT TO THE TERMS OF AECOM'S APPOINTMENT BY ITS CLIENT. AECOM ACCEPTS NO LIABILITY FOR ANY USE OF THIS DOCUMENT OTHER THAN BY ITS ORIGINAL CLIENT OR FOLLOWING AECOM'S EXPRESS AGREEMENT TO SUCH USE, AND ONLY FOR THE PURPOSES FOR WHICH IT WAS PREPARED AND PROVIDED.

| Drawing Number | Highways England PIN | I Originator | I Volume | Rev |
|----------------|----------------------|--------------|----------|-----|
| HE514465       | -ACM                 | -DCO-        |          | P03 |
| Z1_SW_PR_Z     |                      | -DR-CH-1101  |          |     |

Location I Type I Role I Number

**INSET A  
(REFER TO KEY SHEET)**



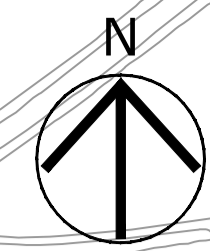
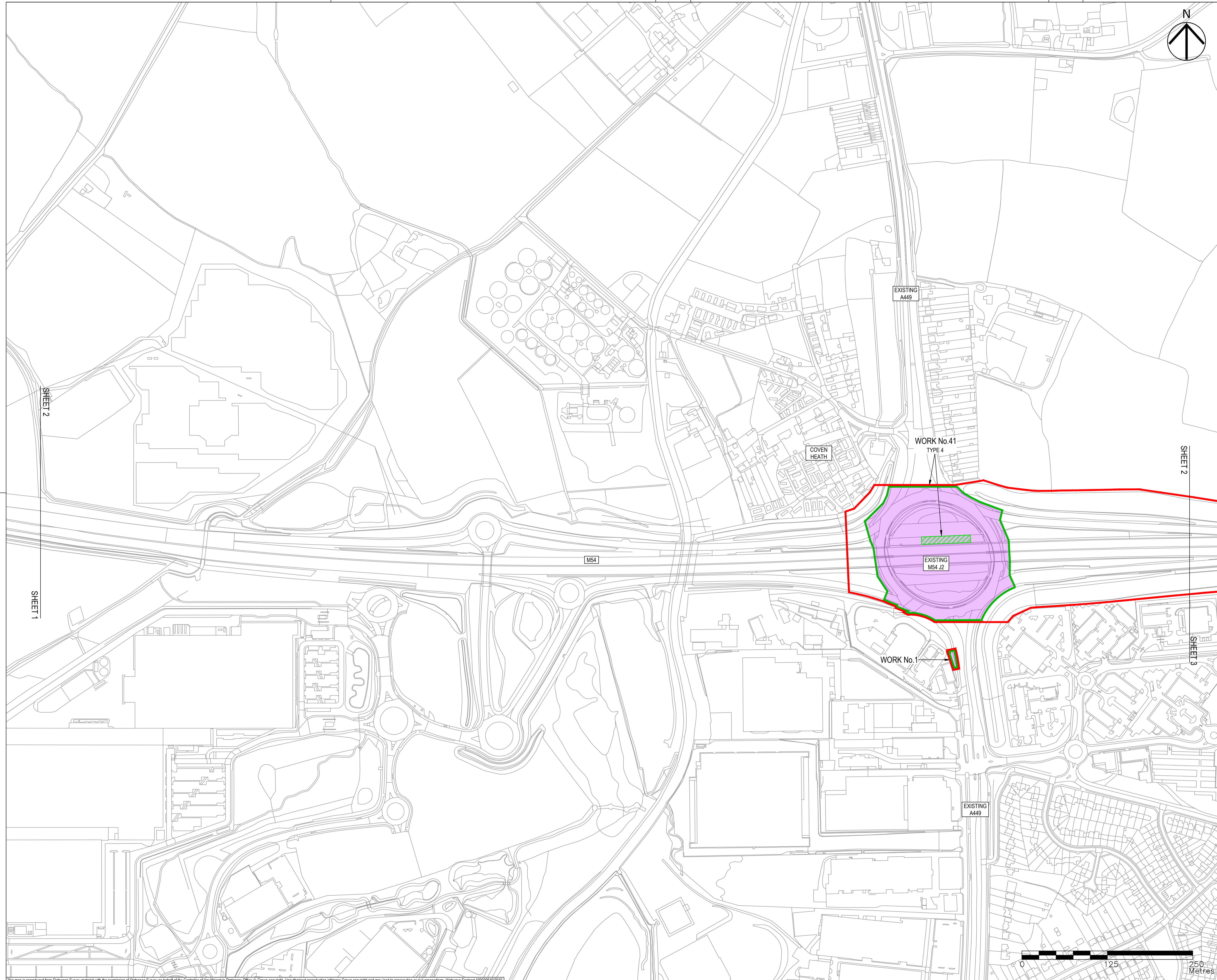

- NOTES**
- THIS DRAWING IS TO BE READ IN CONJUNCTION WITH ALL OTHER RELEVANT DOCUMENTATION.
  - DO NOT SCALE FROM THIS DRAWING, USE ONLY PRINTED DIMENSIONS.
  - ALL DIMENSIONS IN MILLIMETRES. ALL CHAINAGES, LEVELS AND COORDINATES ARE IN METRES UNLESS DEFINED OTHERWISE.
  - THIS DRAWING IS TO BE READ IN CONJUNCTION WITH THE PROJECT HEALTH & SAFETY FILE FOR ANY IDENTIFIED POTENTIAL RISKS.
  - THE WORKS ARE SHOWN ILLUSTRATIVELY ONLY AND ARE SUBJECT TO CHANGE THROUGH DETAILED DESIGN IN ACCORDANCE WITH THE TERMS OF THE DEVELOPMENT CONSENT ORDER.

- KEY**
- LIMITS OF LAND TO BE ACQUIRED OR USED PERMANENTLY OR TEMPORARILY (THE ORDER LIMITS)
  - LAND NOT INCLUDED WITHIN THE ORDER LIMITS
  - COMMENCEMENT OF LINEAR WORKS (APPROX.)
  - TERMINATION OF LINEAR WORKS (APPROX.)
  - HIGHWAY WORK CENTRELINE (APPROX.)
  - NON-LINEAR WORKS BOUNDARY
  - HIGHWAY WORK LIMIT OF DEVIATION
  - ENVIRONMENTAL MITIGATION AREA
  - SITE COMPOUND
  - BORROW PIT LIMITS OF DEVIATION
  - HIGHWAY DRAINAGE ATTENUATION POND
  - UTILITY DIVERSION CENTRELINE (APPROX.)
  - UTILITY DIVERSION LIMITS OF DEVIATION
  - PROPOSED GANTRY LIMIT OF DEVIATION
  - EXISTING GANTRY TO BE ALTERED
  - PROPOSED STRUCTURE
  - TYPE 1 ALTERATION OF PORTAL GANTRY
  - TYPE 2 ALTERATION OF CANTILEVER GANTRY
  - TYPE 3 NEW PORTAL GANTRY
  - TYPE 4 NEW CANTILEVER GANTRY

SHEET 2

SHEET 1

SHEET 2

SHEET 3

|                              |    |       |          |        |
|------------------------------|----|-------|----------|--------|
| First Issue                  | MW | RR    | 18/11/19 | P01    |
| DCO Submission               | JP | RR    | 06/12/19 | P02    |
| DCO Submission Minor Changes | JP | RR    | 28/01/20 | P03    |
| Revision Details             | By | Check | Date     | Suffix |

**DCO APPLICATION**

Client  
Highways England  
Floor 5  
Two Colonnade Square  
38 Colonnade Circus  
Birmingham  
B4 6BN



Development Consent Order Number  
**TR010054**

Project Title  
**M54 to M6 Link Road**

Development Consent Order Drawing Number  
**TR010054/APP/2.4**

Drawing Title  
**WORK PLANS  
REGULATION 5(2)(J)  
SHEET 2 OF 10**

|                                  |       |         |                                   |          |
|----------------------------------|-------|---------|-----------------------------------|----------|
| Designed                         | Drawn | Checked | Approved                          | Date     |
| MW                               | JP    | AM      | RR                                | 28/01/20 |
| Internal Project No.<br>60536736 |       |         | Suitability<br>S8                 |          |
| Scale @ A1<br>1:2500H/1:2500V    |       |         | Zone<br>Development Consent Order |          |

THIS DOCUMENT HAS BEEN PREPARED PURSUANT TO AND SUBJECT TO THE TERMS OF AECOM'S APPOINTMENT BY ITS CLIENT. AECOM ACCEPTS NO LIABILITY FOR ANY USE OF THIS DOCUMENT OTHER THAN BY ITS ORIGINAL CLIENT OR FOLLOWING AECOM'S EXPRESS AGREEMENT TO SUCH USE, AND ONLY FOR THE PURPOSES FOR WHICH IT WAS PREPARED AND PROVIDED.

|                            |                              |                       |                         |            |
|----------------------------|------------------------------|-----------------------|-------------------------|------------|
| Drawing Number<br>HE514465 | Highways England PIN<br>-ACM | I Originator<br>-DCO- | I Volume<br>-DR-CH-1102 | Rev<br>P03 |
| Location<br>Z1_SW_PR_Z     | I Type                       | I Role                | I Number                |            |





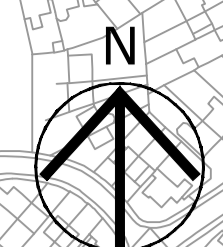
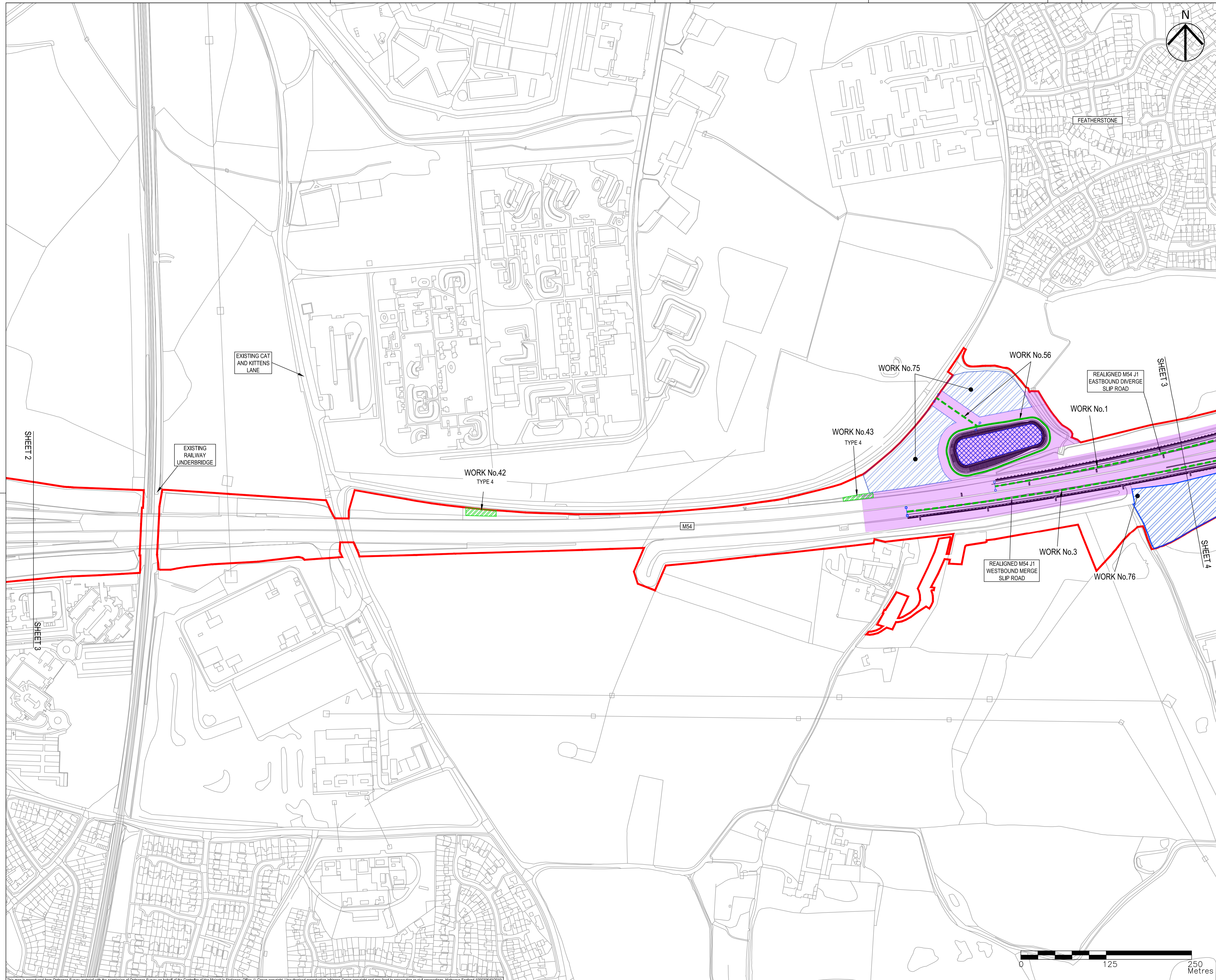

- NOTES**
1. THIS DRAWING IS TO BE READ IN CONJUNCTION WITH ALL OTHER RELEVANT DOCUMENTATION.
  2. DO NOT SCALE FROM THIS DRAWING. USE ONLY PRINTED DIMENSIONS.
  3. ALL DIMENSIONS IN MILLIMETRES. ALL CHAINAGES, LEVELS AND COORDINATES ARE IN METRES UNLESS DEFINED OTHERWISE.
  4. THIS DRAWING IS TO BE READ IN CONJUNCTION WITH THE PROJECT HEALTH & SAFETY FILE FOR ANY IDENTIFIED POTENTIAL RISKS.
  5. THE WORKS ARE SHOWN ILLUSTRATIVELY ONLY AND ARE SUBJECT TO CHANGE THROUGH DETAILED DESIGN IN ACCORDANCE WITH THE TERMS OF THE DEVELOPMENT CONSENT ORDER.

- KEY**
- LIMITS OF LAND TO BE ACQUIRED OR USED PERMANENTLY OR TEMPORARILY (THE ORDER LIMITS)
  - LAND NOT INCLUDED WITHIN THE ORDER LIMITS
  - COMMENCEMENT OF LINEAR WORKS (APPROX.)
  - TERMINATION OF LINEAR WORKS (APPROX.)
  - HIGHWAY WORK CENTRELINE (APPROX.)
  - NON-LINEAR WORKS BOUNDARY
  - HIGHWAY WORK LIMIT OF DEVIATION
  - ENVIRONMENTAL MITIGATION AREA
  - SITE COMPOUND
  - BORROW PIT LIMITS OF DEVIATION
  - HIGHWAY DRAINAGE ATTENUATION POND
  - UTILITY DIVERSION CENTRELINE (APPROX.)
  - UTILITY DIVERSION LIMITS OF DEVIATION
  - PROPOSED GANTRY LIMIT OF DEVIATION
  - EXISTING GANTRY TO BE ALTERED
  - PROPOSED STRUCTURE
  - TYPE 1 ALTERATION OF PORTAL GANTRY
  - TYPE 2 ALTERATION OF CANTILEVER GANTRY
  - TYPE 3 NEW PORTAL GANTRY
  - TYPE 4 NEW CANTILEVER GANTRY

|                              |       |    |          |        |
|------------------------------|-------|----|----------|--------|
| First Issue                  | MW    | RR | 18/11/19 | P01    |
| DCO Submission               | JP    | RR | 06/12/19 | P02    |
| DCO Submission Minor Changes | JP    | RR | 28/01/20 | P03    |
| Revision Details             | By    | RR | Date     | Suffix |
|                              | Check |    |          |        |

**DCO APPLICATION**

Client  
Highways England  
Floor 5  
Two Colonnade Square  
38 Colonnade Circus  
Birmingham  
B4 6BN



Development Consent Order Number  
**TR010054**

Project Title  
**M54 to M6 Link Road**

Development Consent Order Drawing Number  
**TR010054/APP/2.4**

Drawing Title  
**WORK PLANS  
REGULATION 5(2)(J)  
SHEET 3 OF 10**

|                                  |                                   |         |          |          |
|----------------------------------|-----------------------------------|---------|----------|----------|
| Designed                         | Drawn                             | Checked | Approved | Date     |
| MW                               | JP                                | AM      | RR       | 28/01/20 |
| Internal Project No.<br>60536736 | Suitability<br>S8                 |         |          |          |
| Scale @ A1<br>1:2500H/1:2500V    | Zone<br>Development Consent Order |         |          |          |

THIS DOCUMENT HAS BEEN PREPARED PURSUANT TO AND SUBJECT TO THE TERMS OF AECOM'S APPOINTMENT BY ITS CLIENT. AECOM ACCEPTS NO LIABILITY FOR ANY USE OF THIS DOCUMENT OTHER THAN BY ITS ORIGINAL CLIENT OR FOLLOWING AECOM'S EXPRESS AGREEMENT TO SUCH USE, AND ONLY FOR THE PURPOSES FOR WHICH IT WAS PREPARED AND PROVIDED.

|                            |                    |                 |                |
|----------------------------|--------------------|-----------------|----------------|
| Drawing Number<br>HE514465 | Originator<br>-ACM | Volume<br>-DCO- | Rev<br>P03     |
| Location<br>Z1_SW_PR_Z     | Drawn<br>-DR-      | Check<br>-CH-   | Number<br>1103 |

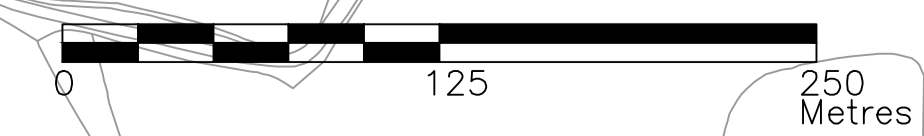



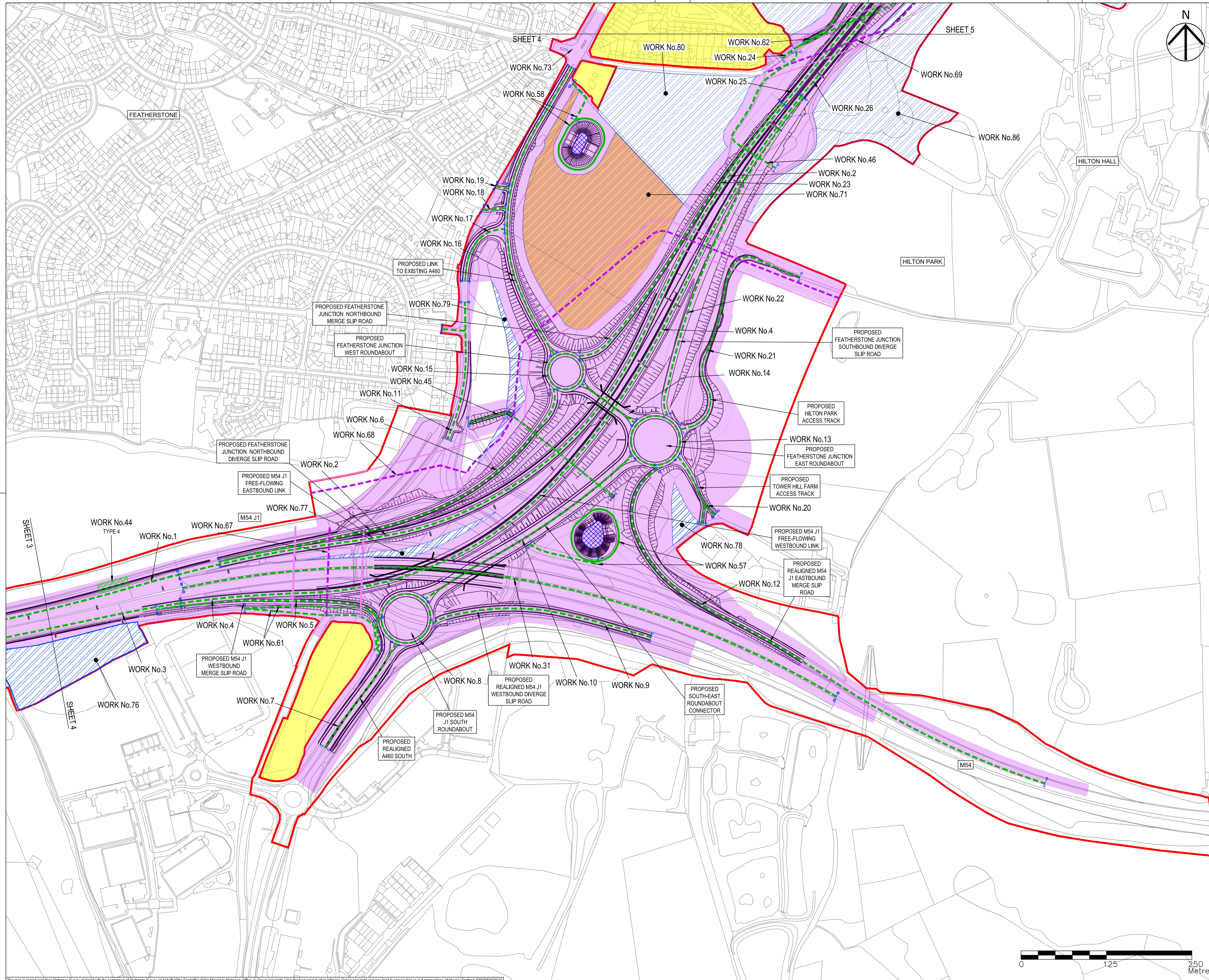

- NOTES**
- THIS DRAWING IS TO BE READ IN CONJUNCTION WITH ALL OTHER RELEVANT DOCUMENTATION.
  - DO NOT SCALE FROM THIS DRAWING. USE ONLY PRINTED DIMENSIONS.
  - ALL DIMENSIONS IN MILLIMETRES. ALL CHAINAGES, LEVELS AND COORDINATES ARE IN METRES UNLESS DEFINED OTHERWISE.
  - THIS DRAWING IS TO BE READ IN CONJUNCTION WITH THE PROJECT HEALTH & SAFETY FILE FOR ANY IDENTIFIED POTENTIAL RISKS.
  - THE WORKS ARE SHOWN ILLUSTRATIVELY ONLY AND ARE SUBJECT TO CHANGE THROUGH DETAILED DESIGN IN ACCORDANCE WITH THE TERMS OF THE DEVELOPMENT CONSENT ORDER.

- KEY**
- LIMITS OF LAND TO BE ACQUIRED OR USED PERMANENTLY OR TEMPORARILY (THE ORDER LIMITS)
  - LAND NOT INCLUDED WITHIN THE ORDER LIMITS
  - COMMENCEMENT OF LINEAR WORKS (APPROX.)
  - TERMINATION OF LINEAR WORKS (APPROX.)
  - HIGHWAY WORK CENTRELINE (APPROX.)
  - NON-LINEAR WORKS BOUNDARY
  - HIGHWAY WORK LIMIT OF DEVIATION
  - ENVIRONMENTAL MITIGATION AREA
  - SITE COMPOUND
  - BORROW PIT LIMITS OF DEVIATION
  - HIGHWAY DRAINAGE ATTENUATION POND
  - UTILITY DIVERSION CENTRELINE (APPROX.)
  - UTILITY DIVERSION LIMITS OF DEVIATION
  - PROPOSED GANTRY LIMIT OF DEVIATION
  - EXISTING GANTRY TO BE ALTERED
  - PROPOSED STRUCTURE
  - TYPE 1 ALTERATION OF PORTAL GANTRY
  - TYPE 2 ALTERATION OF CANTILEVER GANTRY
  - TYPE 3 NEW PORTAL GANTRY
  - TYPE 4 NEW CANTILEVER GANTRY

| Revision                     | By | Check | Date     | Suffix |
|------------------------------|----|-------|----------|--------|
| First Issue                  | MW | RR    | 19/11/19 | P01    |
| DCO Submission               | JP | RR    | 06/12/19 | P02    |
| DCO Submission Minor Changes | JP | RR    | 28/01/20 | P03    |

**DCO APPLICATION**

Client  
Highways England  
Floor 5  
Two Colonnade Square  
38 Colonnade Circus  
Birmingham  
B4 6BN

Development Consent Order Number  
**TR010054**

Project Title  
**M54 to M6 Link Road**



Development Consent Order Drawing Number  
**TR010054/APP/2.4**

Drawing Title  
**WORK PLANS  
REGULATION 5(2)(J)  
SHEET 4 OF 10**

| Designed | Drawn | Checked | Approved | Date     |
|----------|-------|---------|----------|----------|
| MW       | JP    | AM      | RR       | 28/01/20 |

Internal Project No. 60536736  
Scale @ A1 1:2500H/1:2500V  
Suitability S8  
Zone Development Consent Order

| Drawing Number | Highways England PIN | Originator  | I Volume | Rev |
|----------------|----------------------|-------------|----------|-----|
| HE514465       | -ACM                 | -DCO-       |          | P03 |
| Z1_SW_PR_Z     |                      | -DR-CH-1104 |          |     |

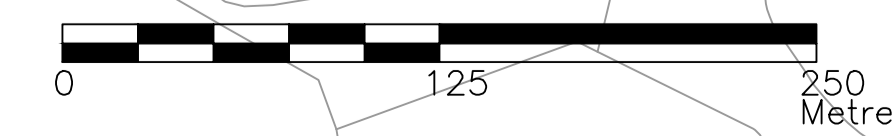

This map is reproduced from Ordnance Survey material with the permission of Ordnance Survey on behalf of the Controller of Her Majesty's Stationery Office. Crown copyright. Unauthorised reproduction infringes Crown copyright and may lead to prosecution or civil proceedings. Highways England 100030649(2019)



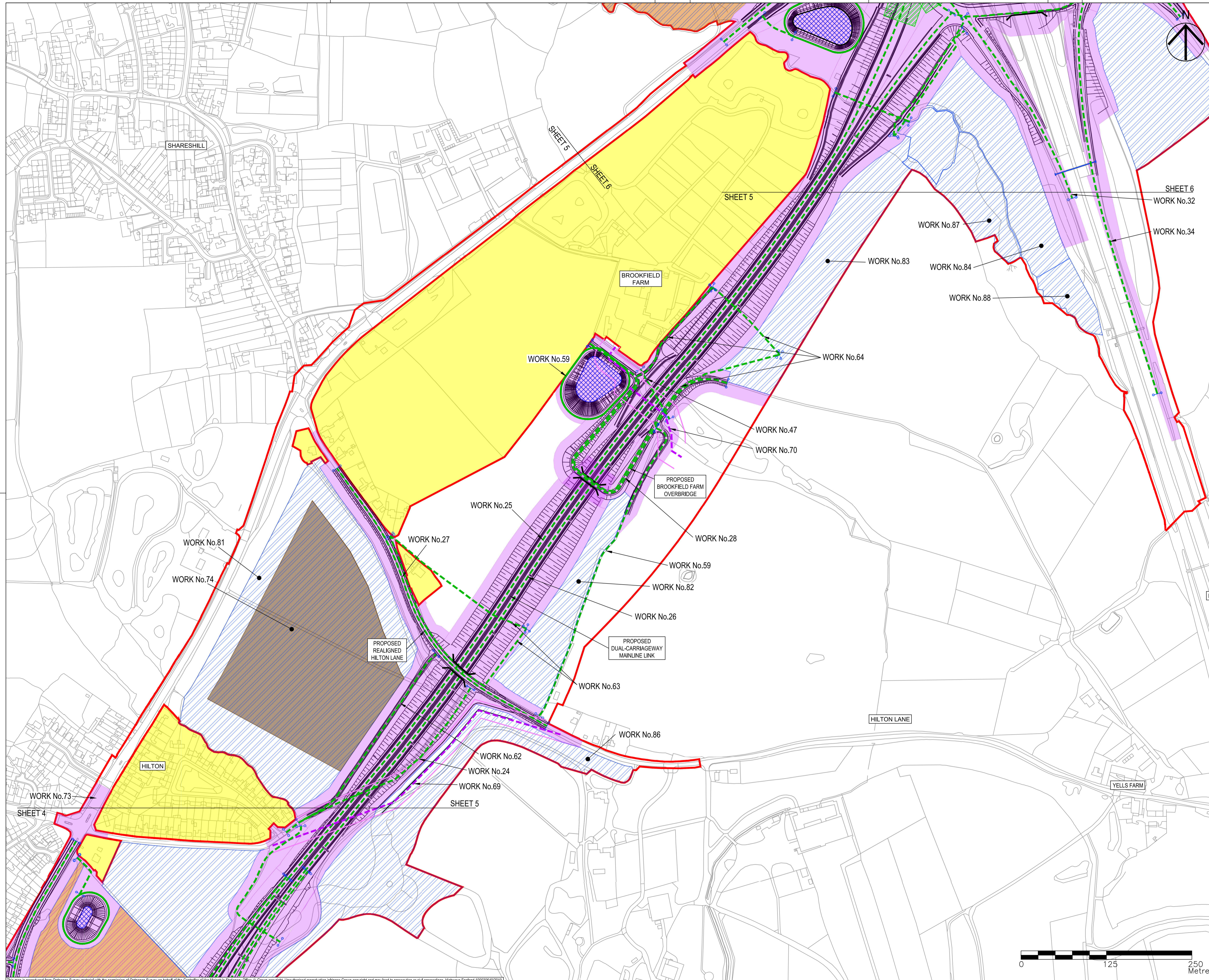

- NOTES**
- THIS DRAWING IS TO BE READ IN CONJUNCTION WITH ALL OTHER RELEVANT DOCUMENTATION.
  - DO NOT SCALE FROM THIS DRAWING, USE ONLY PRINTED DIMENSIONS.
  - ALL DIMENSIONS IN MILLIMETRES. ALL CHAINAGES, LEVELS AND COORDINATES ARE IN METRES UNLESS DEFINED OTHERWISE.
  - THIS DRAWING IS TO BE READ IN CONJUNCTION WITH THE PROJECT HEALTH & SAFETY FILE FOR ANY IDENTIFIED POTENTIAL RISKS.
  - THE WORKS ARE SHOWN ILLUSTRATIVELY ONLY AND ARE SUBJECT TO CHANGE THROUGH DETAILED DESIGN IN ACCORDANCE WITH THE TERMS OF THE DEVELOPMENT CONSENT ORDER.

- KEY**
- LIMITS OF LAND TO BE ACQUIRED OR USED PERMANENTLY OR TEMPORARILY (THE ORDER LIMITS)
  - LAND NOT INCLUDED WITHIN THE ORDER LIMITS
  - COMMENCEMENT OF LINEAR WORKS (APPROX.)
  - TERMINATION OF LINEAR WORKS (APPROX.)
  - HIGHWAY WORK CENTRELINE (APPROX.)
  - NON-LINEAR WORKS BOUNDARY
  - HIGHWAY WORK LIMIT OF DEVIATION
  - ENVIRONMENTAL MITIGATION AREA
  - SITE COMPOUND
  - BORROW PIT LIMITS OF DEVIATION
  - HIGHWAY DRAINAGE ATTENUATION POND
  - UTILITY DIVERSION CENTRELINE (APPROX.)
  - UTILITY DIVERSION LIMITS OF DEVIATION
  - PROPOSED GANTRY LIMIT OF DEVIATION
  - + EXISTING GANTRY TO BE ALTERED
  - + PROPOSED STRUCTURE
  - TYPE 1 ALTERATION OF PORTAL GANTRY
  - TYPE 2 ALTERATION OF CANTILEVER GANTRY
  - TYPE 3 NEW PORTAL GANTRY
  - TYPE 4 NEW CANTILEVER GANTRY

| Revision | By | Check | Date     | Suffix |
|----------|----|-------|----------|--------|
| 1        | MW | RR    | 19/11/19 | P01    |
| 2        | JP | RR    | 06/12/19 | P02    |
| 3        | JP | RR    | 28/01/20 | P03    |

**DCO APPLICATION**

Client  
Highways England  
Floor 5  
Two Colonnade Square  
38 Colonnade Circus  
Birmingham  
B4 6BN



Development Consent Order Number  
**TR010054**

Project Title  
**M54 to M6 Link Road**

Development Consent Order Drawing Number  
**TR010054/APP/2.4**

Drawing Title  
**WORK PLANS  
REGULATION 5(2)(J)  
SHEET 5 OF 10**

| Designed | Drawn | Checked | Approved | Date     |
|----------|-------|---------|----------|----------|
| MW       | JP    | AM      | RR       | 28/01/20 |

Internal Project No. 60536736  
Scale @ A1 1:2500H/1:2500V  
Zone Development Consent Order

| Drawing Number | Highways England PIN | I Originator | I Volume | Rev      |
|----------------|----------------------|--------------|----------|----------|
| HE514465       | -ACM                 | -DCO-        |          | P03      |
| Z2_SW_PR_Z     |                      | -DR-CH-1105  |          |          |
| Location       |                      | I Type       | I Role   | I Number |

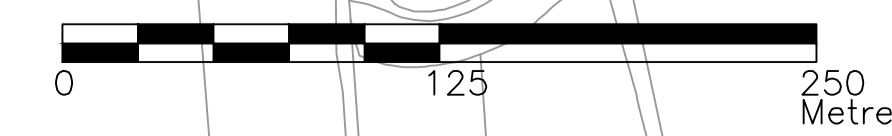

This map is reproduced from Ordnance Survey material with the permission of Ordnance Survey on behalf of the Controller of Her Majesty's Stationery Office. © Crown copyright. Unauthorised reproduction infringes Crown copyright and may lead to prosecution or civil proceedings. Highways England 100030649/2019.



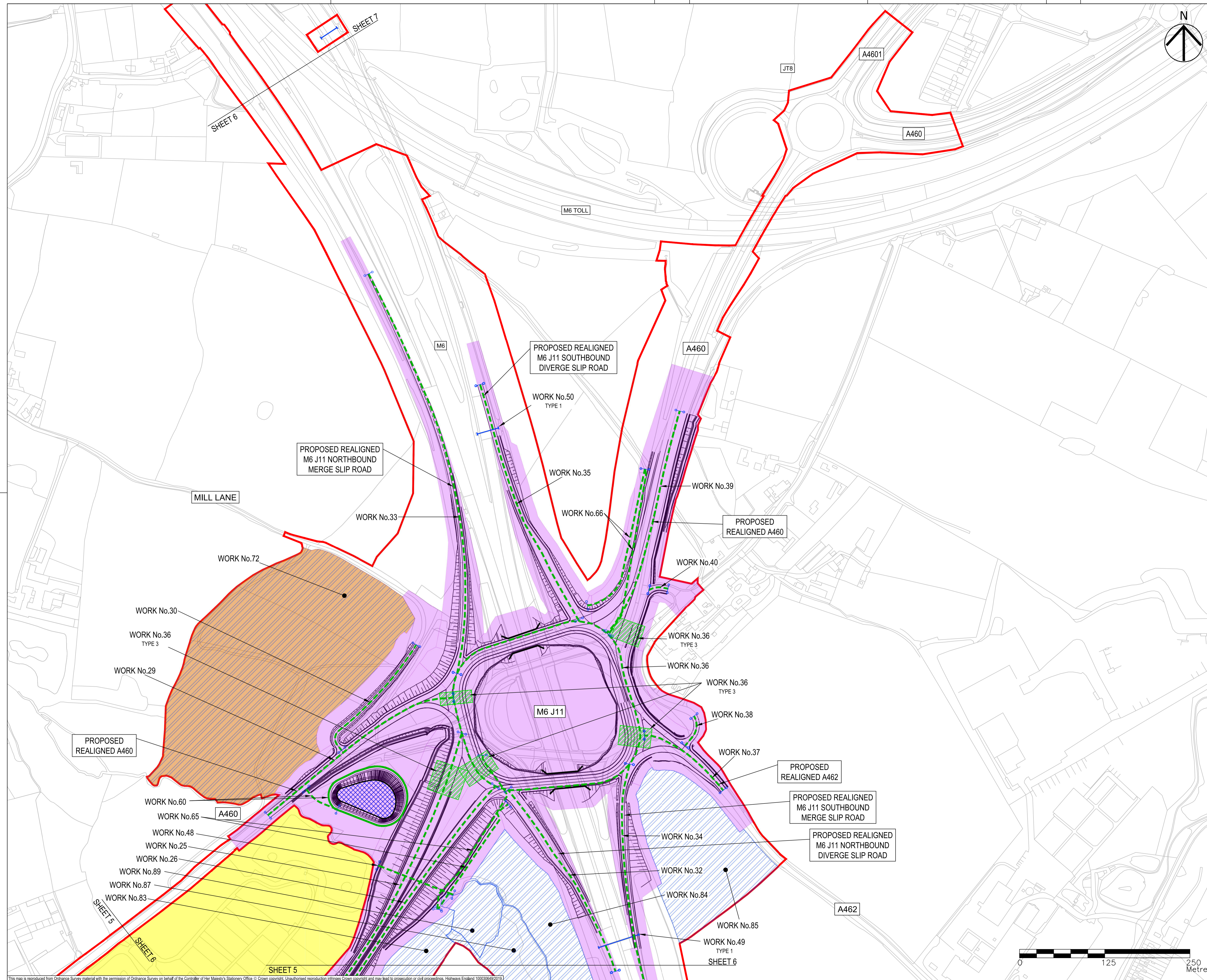

- NOTES**
- THIS DRAWING IS TO BE READ IN CONJUNCTION WITH ALL OTHER RELEVANT DOCUMENTATION.
  - DO NOT SCALE FROM THIS DRAWING, USE ONLY PRINTED DIMENSIONS.
  - ALL DIMENSIONS IN MILLIMETRES. ALL CHAINAGES, LEVELS AND COORDINATES ARE IN METRES UNLESS DEFINED OTHERWISE.
  - THIS DRAWING IS TO BE READ IN CONJUNCTION WITH THE PROJECT HEALTH & SAFETY FILE FOR ANY IDENTIFIED POTENTIAL RISKS.
  - THE WORKS ARE SHOWN ILLUSTRATIVELY ONLY AND ARE SUBJECT TO CHANGE THROUGH DETAILED DESIGN IN ACCORDANCE WITH THE TERMS OF THE DEVELOPMENT CONSENT ORDER.

- KEY**
- LIMITS OF LAND TO BE ACQUIRED OR USED PERMANENTLY OR TEMPORARILY (THE ORDER LIMITS)
  - LAND NOT INCLUDED WITHIN THE ORDER LIMITS
  - COMMENCEMENT OF LINEAR WORKS (APPROX.)
  - TERMINATION OF LINEAR WORKS (APPROX.)
  - HIGHWAY WORK CENTRELINE (APPROX.)
  - NON-LINEAR WORKS BOUNDARY
  - HIGHWAY WORK LIMIT OF DEVIATION
  - ENVIRONMENTAL MITIGATION AREA
  - SITE COMPOUND
  - BORROW PIT LIMITS OF DEVIATION
  - HIGHWAY DRAINAGE ATTENUATION POND
  - UTILITY DIVERSION CENTRELINE (APPROX.)
  - UTILITY DIVERSION LIMITS OF DEVIATION
  - PROPOSED GANTRY LIMIT OF DEVIATION
  - EXISTING GANTRY TO BE ALTERED
  - PROPOSED STRUCTURE
  - TYPE 1 ALTERATION OF PORTAL GANTRY
  - TYPE 2 ALTERATION OF CANTILEVER GANTRY
  - TYPE 3 NEW PORTAL GANTRY
  - TYPE 4 NEW CANTILEVER GANTRY

|                              |       |    |          |        |
|------------------------------|-------|----|----------|--------|
| First Issue                  | MW    | RR | 18/11/19 | P01    |
| DCO Submission               | JP    | RR | 06/12/19 | P02    |
| DCO Submission Minor Changes | JP    | RR | 28/01/20 | P03    |
| Revision Details             | By    | RR | Date     | Suffix |
|                              | Check |    |          |        |

**DCO APPLICATION**

Client  
Highways England  
Floor 5  
Two Colonn Square  
38 Colonn Square  
Birmingham  
B4 6BN



Development Consent Order Number  
**TR010054**

Project Title  
**M54 to M6 Link Road**

Development Consent Order Drawing Number  
**TR010054/APP/2.4**

Drawing Title  
**WORK PLANS  
REGULATION 5(2)(J)  
SHEET 6 OF 10**

|                      |                 |    |             |                           |      |          |
|----------------------|-----------------|----|-------------|---------------------------|------|----------|
| Designed             | MW              | JP | AM          | RR                        | Date | 28/01/20 |
| Internal Project No. | 60536736        |    | Suitability | SB                        |      |          |
| Scale @ A1           | 1:2500H/1:2500V |    | Zone        | Development Consent Order |      |          |

THIS DOCUMENT HAS BEEN PREPARED PURSUANT TO AND SUBJECT TO THE TERMS OF AECOM'S APPOINTMENT BY ITS CLIENT. AECOM ACCEPTS NO LIABILITY FOR ANY USE OF THIS DOCUMENT OTHER THAN BY ITS ORIGINAL CLIENT OR FOLLOWING AECOM'S EXPRESS AGREEMENT TO SUCH USE, AND ONLY FOR THE PURPOSES FOR WHICH IT WAS PREPARED AND PROVIDED.

|                |                      |              |            |          |
|----------------|----------------------|--------------|------------|----------|
| Drawing Number | Highways England PIN | I Originator | I Volume   | Rev      |
| HE514465       | -ACM                 | -DCO-        | Z3 SW_PR_Z | P03      |
| Location       |                      | I Type       | I Role     | I Number |
|                |                      | -DR-CH-1106  |            |          |

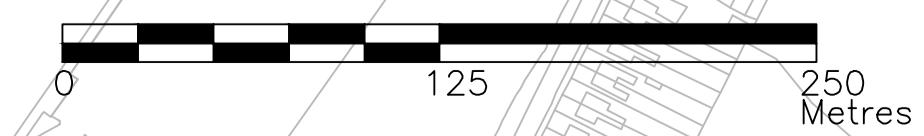

This map is reproduced from Ordnance Survey material with the permission of Ordnance Survey on behalf of the Controller of Her Majesty's Stationery Office. Crown copyright. Unauthorised reproduction infringes Crown copyright and may lead to prosecution or civil proceedings. Highways England 100030849(2019)



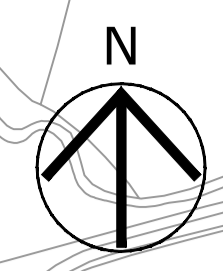
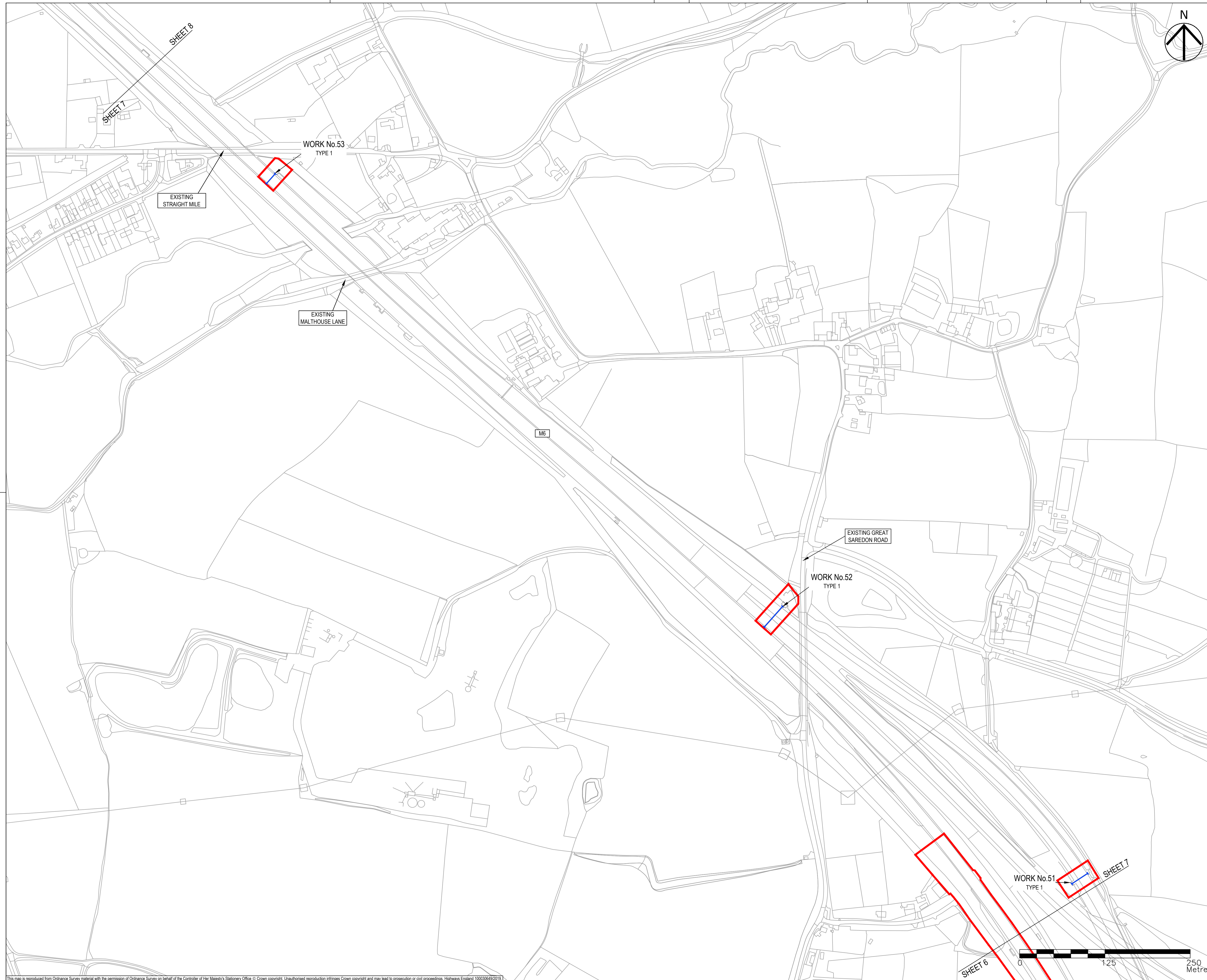

- NOTES**
- THIS DRAWING IS TO BE READ IN CONJUNCTION WITH ALL OTHER RELEVANT DOCUMENTATION.
  - DO NOT SCALE FROM THIS DRAWING. USE ONLY PRINTED DIMENSIONS.
  - ALL DIMENSIONS IN MILLIMETRES. ALL CHAINAGES, LEVELS AND COORDINATES ARE IN METRES UNLESS DEFINED OTHERWISE.
  - THIS DRAWING IS TO BE READ IN CONJUNCTION WITH THE PROJECT HEALTH & SAFETY FILE FOR ANY IDENTIFIED POTENTIAL RISKS.
  - THE WORKS ARE SHOWN ILLUSTRATIVELY ONLY AND ARE SUBJECT TO CHANGE THROUGH DETAILED DESIGN IN ACCORDANCE WITH THE TERMS OF THE DEVELOPMENT CONSENT ORDER.

- KEY**
- LIMITS OF LAND TO BE ACQUIRED OR USED PERMANENTLY OR TEMPORARILY (THE ORDER LIMITS)
  - LAND NOT INCLUDED WITHIN THE ORDER LIMITS
  - COMMENCEMENT OF LINEAR WORKS (APPROX.)
  - TERMINATION OF LINEAR WORKS (APPROX.)
  - HIGHWAY WORK CENTRELINE (APPROX.)
  - NON-LINEAR WORKS BOUNDARY
  - HIGHWAY WORK LIMIT OF DEVIATION
  - ENVIRONMENTAL MITIGATION AREA
  - SITE COMPOUND
  - BORROW PIT LIMITS OF DEVIATION
  - HIGHWAY DRAINAGE ATTENUATION POND
  - UTILITY DIVERSION CENTRELINE (APPROX.)
  - UTILITY DIVERSION LIMITS OF DEVIATION
  - PROPOSED GANTRY LIMIT OF DEVIATION
  - EXISTING GANTRY TO BE ALTERED
  - PROPOSED STRUCTURE
  - TYPE 1 ALTERATION OF PORTAL GANTRY
  - TYPE 2 ALTERATION OF CANTILEVER GANTRY
  - TYPE 3 NEW PORTAL GANTRY
  - TYPE 4 NEW CANTILEVER GANTRY

| Revision Details             | By | Date     | Suffix |
|------------------------------|----|----------|--------|
| First Issue                  | MW | 18/11/19 | P01    |
| DCO Submission               | JP | 06/12/19 | P02    |
| DCO Submission Minor Changes | JP | 28/01/20 | P03    |

**DCO APPLICATION**

Client  
Highways England  
Floor 5  
Two Colonnade Square  
38 Colonnade Circus  
Birmingham  
B4 6BN

Development Consent Order Number  
**TR010054**

Project Title  
**M54 to M6 Link Road**

Development Consent Order Drawing Number  
**TR010054/APP/2.4**

Drawing Title  
**WORK PLANS  
REGULATION 5(2)(J)  
SHEET 7 OF 10**

| Designed | Drawn | Checked | Approved | Date     |
|----------|-------|---------|----------|----------|
| MW       | JP    | AM      | RR       | 28/01/20 |

Internal Project No. 60536736  
Scale @ A1 1:2500H/1:2500V  
Suitability S8  
Zone Development Consent Order

THIS DOCUMENT HAS BEEN PREPARED PURSUANT TO AND SUBJECT TO THE TERMS OF AECOM'S APPOINTMENT BY ITS CLIENT. AECOM ACCEPTS NO LIABILITY FOR ANY USE OF THIS DOCUMENT OTHER THAN BY ITS ORIGINAL CLIENT OR FOLLOWING AECOM'S EXPRESS AGREEMENT TO SUCH USE, AND ONLY FOR THE PURPOSES FOR WHICH IT WAS PREPARED AND PROVIDED.

|   |                              |                           |                   |
|---|------------------------------|---------------------------|-------------------|
| Drawing Number<br>Highways England PIN<br><b>HE514465</b> | Originator<br><b>-ACM</b>    | Volume<br><b>-DCO-</b>    | Rev<br><b>P03</b> |
| Location<br><b>Z3 SW_PR_Z</b>                             | I Type<br><b>-DR-CH-1107</b> | I Role<br><b>I Number</b> |                   |

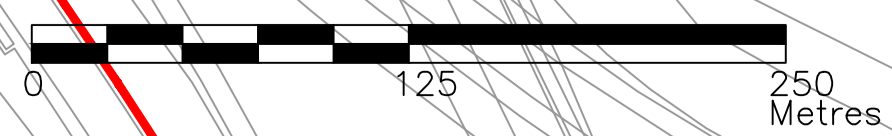

This map is reproduced from Ordnance Survey material with the permission of Ordnance Survey on behalf of the Controller of Her Majesty's Stationery Office. © Crown copyright. Unauthorised reproduction infringes Crown copyright and may lead to prosecution or civil proceedings. Highways England 1000305492019



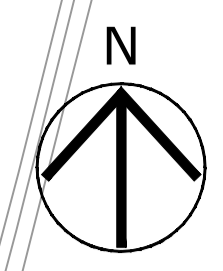
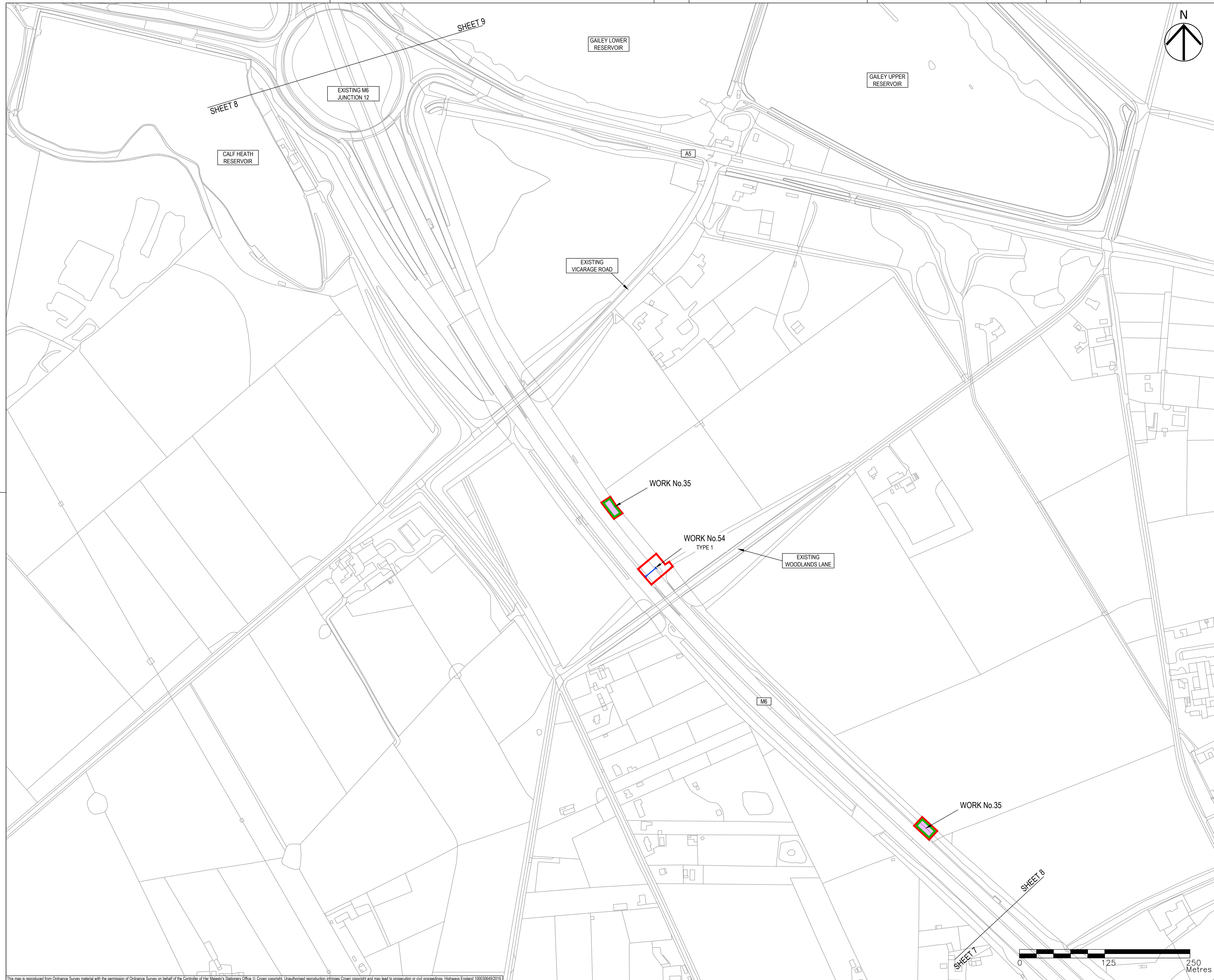

- NOTES**
- THIS DRAWING IS TO BE READ IN CONJUNCTION WITH ALL OTHER RELEVANT DOCUMENTATION.
  - DO NOT SCALE FROM THIS DRAWING. USE ONLY PRINTED DIMENSIONS.
  - ALL DIMENSIONS IN MILLIMETRES. ALL CHAINAGES, LEVELS AND COORDINATES ARE IN METRES UNLESS DEFINED OTHERWISE.
  - THIS DRAWING IS TO BE READ IN CONJUNCTION WITH THE PROJECT HEALTH & SAFETY FILE FOR ANY IDENTIFIED POTENTIAL RISKS.
  - THE WORKS ARE SHOWN ILLUSTRATIVELY ONLY AND ARE SUBJECT TO CHANGE THROUGH DETAILED DESIGN IN ACCORDANCE WITH THE TERMS OF THE DEVELOPMENT CONSENT ORDER.

- KEY**
- LIMITS OF LAND TO BE ACQUIRED OR USED PERMANENTLY OR TEMPORARILY (THE ORDER LIMITS)
  - LAND NOT INCLUDED WITHIN THE ORDER LIMITS
  - COMMENCEMENT OF LINEAR WORKS (APPROX.)
  - TERMINATION OF LINEAR WORKS (APPROX.)
  - HIGHWAY WORK CENTRELINE (APPROX.)
  - NON-LINEAR WORKS BOUNDARY
  - HIGHWAY WORK LIMIT OF DEVIATION
  - ENVIRONMENTAL MITIGATION AREA
  - SITE COMPOUND
  - BORROW PIT LIMITS OF DEVIATION
  - HIGHWAY DRAINAGE ATTENUATION POND
  - UTILITY DIVERSION CENTRELINE (APPROX.)
  - UTILITY DIVERSION LIMITS OF DEVIATION
  - PROPOSED GANTRY LIMIT OF DEVIATION
  - └ EXISTING GANTRY TO BE ALTERED
  - PROPOSED STRUCTURE
  - TYPE 1 ALTERATION OF PORTAL GANTRY
  - TYPE 2 ALTERATION OF CANTILEVER GANTRY
  - TYPE 3 NEW PORTAL GANTRY
  - TYPE 4 NEW CANTILEVER GANTRY

|                              |    |       |          |        |
|------------------------------|----|-------|----------|--------|
| First Issue                  | MW | RR    | 18/11/19 | P01    |
| DCO Submission               | JP | RR    | 06/12/19 | P02    |
| DCO Submission Minor Changes | JP | RR    | 28/01/20 | P03    |
| Revision Details             | By | Check | Date     | Suffix |

**DCO APPLICATION**

Client  
**Highways England**  
 Floor 5  
 Two Colonnade Square  
 38 Colonnade Circus  
 Birmingham  
 B4 6BN



Development Consent Order Number  
**TR010054**

Project Title  
**M54 to M6 Link Road**

Development Consent Order Drawing Number  
**TR010054/APP/2.4**

Drawing Title  
**WORK PLANS  
 REGULATION 5(2)(J)  
 SHEET 8 OF 10**

|                      |                 |       |    |             |                           |          |    |      |          |
|----------------------|-----------------|-------|----|-------------|---------------------------|----------|----|------|----------|
| Designed             | MW              | Drawn | JP | Checked     | AM                        | Approved | RR | Date | 28/01/20 |
| Internal Project No. | 60536736        |       |    | Suitability | S8                        |          |    |      |          |
| Scale @ A1           | 1:2500H/1:2500V |       |    | Zone        | Development Consent Order |          |    |      |          |

THIS DOCUMENT HAS BEEN PREPARED PURSUANT TO AND SUBJECT TO THE TERMS OF AECOM'S APPOINTMENT BY ITS CLIENT. AECOM ACCEPTS NO LIABILITY FOR ANY USE OF THIS DOCUMENT OTHER THAN BY ITS ORIGINAL CLIENT OR FOLLOWING AECOM'S EXPRESS AGREEMENT TO SUCH USE, AND ONLY FOR THE PURPOSES FOR WHICH IT WAS PREPARED AND PROVIDED.

|                 |                      |                        |            |     |
|-----------------|----------------------|------------------------|------------|-----|
| Drawing Number  | Highways England PIN | I Originator           | I Volume   | Rev |
| <b>HE514465</b> | <b>-ACM</b>          | <b>-DCO-</b>           | <b>P03</b> |     |
| Location        | <b>Z3 SW_PR_Z</b>    | <b>-DR-CH-1108</b>     |            |     |
|                 |                      | I Type I Role I Number |            |     |

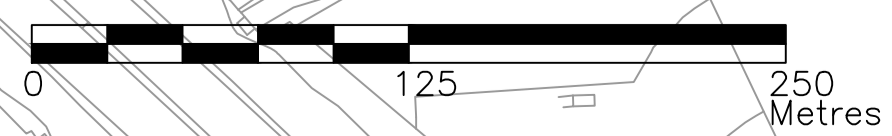



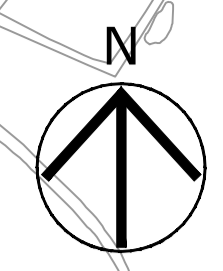
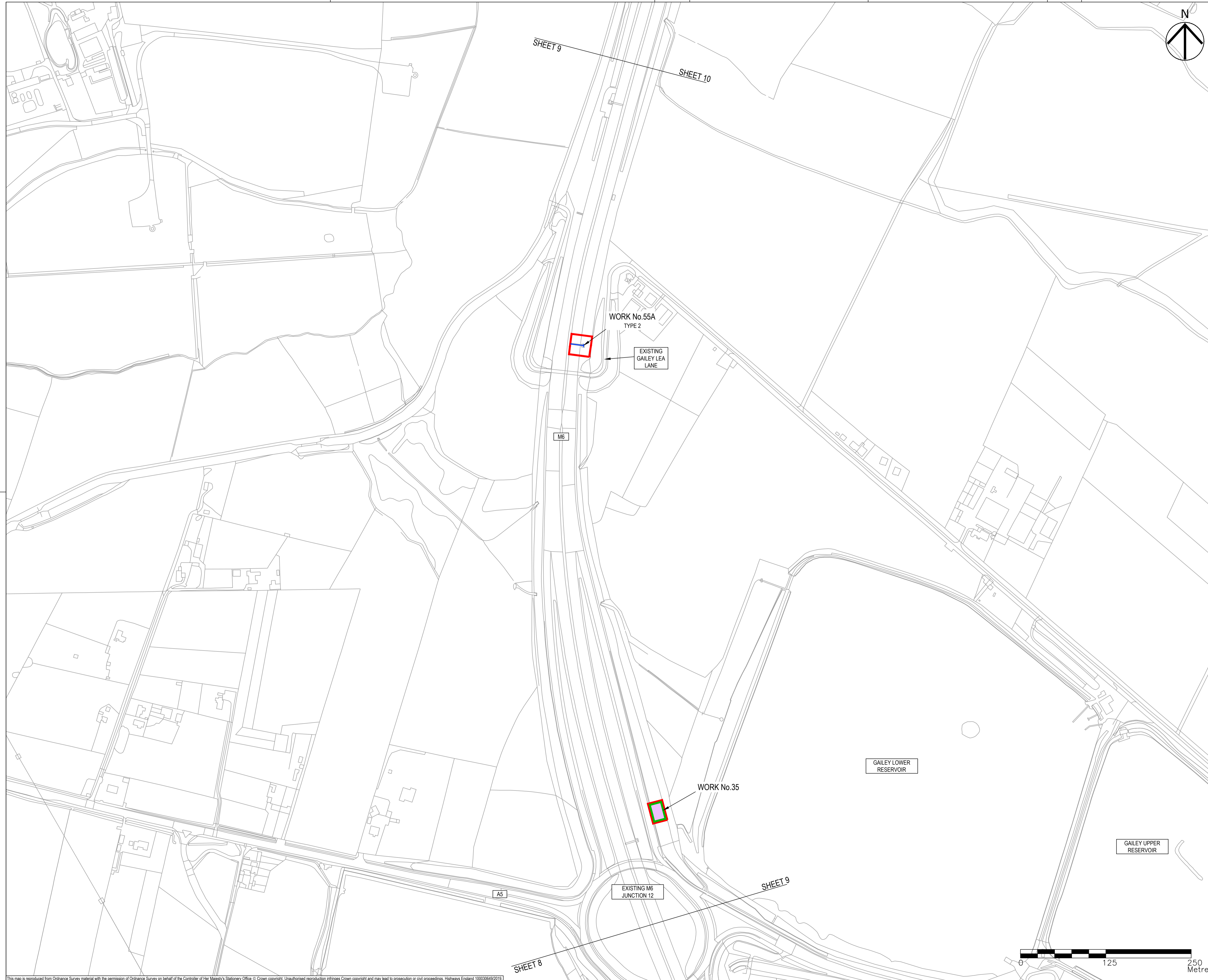

- NOTES**
- THIS DRAWING IS TO BE READ IN CONJUNCTION WITH ALL OTHER RELEVANT DOCUMENTATION.
  - DO NOT SCALE FROM THIS DRAWING. USE ONLY PRINTED DIMENSIONS.
  - ALL DIMENSIONS IN MILLIMETRES. ALL CHAINAGES, LEVELS AND COORDINATES ARE IN METRES UNLESS DEFINED OTHERWISE.
  - THIS DRAWING IS TO BE READ IN CONJUNCTION WITH THE PROJECT HEALTH & SAFETY FILE FOR ANY IDENTIFIED POTENTIAL RISKS.
  - THE WORKS ARE SHOWN ILLUSTRATIVELY ONLY AND ARE SUBJECT TO CHANGE THROUGH DETAILED DESIGN IN ACCORDANCE WITH THE TERMS OF THE DEVELOPMENT CONSENT ORDER.

- KEY**
- LIMITS OF LAND TO BE ACQUIRED OR USED PERMANENTLY OR TEMPORARILY (THE ORDER LIMITS)
  - LAND NOT INCLUDED WITHIN THE ORDER LIMITS
  - COMMENCEMENT OF LINEAR WORKS (APPROX.)
  - TERMINATION OF LINEAR WORKS (APPROX.)
  - HIGHWAY WORK CENTRELINE (APPROX.)
  - NON-LINEAR WORKS BOUNDARY
  - HIGHWAY WORK LIMIT OF DEVIATION
  - ENVIRONMENTAL MITIGATION AREA
  - SITE COMPOUND
  - BORROW PIT LIMITS OF DEVIATION
  - HIGHWAY DRAINAGE ATTENUATION POND
  - UTILITY DIVERSION CENTRELINE (APPROX.)
  - UTILITY DIVERSION LIMITS OF DEVIATION
  - PROPOSED GANTRY LIMIT OF DEVIATION
  - |— EXISTING GANTRY TO BE ALTERED
  - PROPOSED STRUCTURE
  - TYPE 1 ALTERATION OF PORTAL GANTRY
  - TYPE 2 ALTERATION OF CANTILEVER GANTRY
  - TYPE 3 NEW PORTAL GANTRY
  - TYPE 4 NEW CANTILEVER GANTRY

| Revision Details             | By | Date     | Suffix |
|------------------------------|----|----------|--------|
| First Issue                  | MW | 18/11/19 | P01    |
| DCO Submission               | JP | 06/12/19 | P02    |
| DCO Submission Minor Changes | JP | 28/01/20 | P03    |

**DCO APPLICATION**

Client  
**Highways England**  
 Floor 5  
 Two Colmore Square  
 38 Colmore Circus  
 Birmingham  
 B4 6BN



Development Consent Order Number  
**TR010054**

Project Title  
**M54 to M6 Link Road**

Development Consent Order Drawing Number  
**TR010054/APP/2.4**

Drawing Title  
**WORK PLANS  
 REGULATION 5(2)(J)  
 SHEET 9 OF 10**

| Designed | Drawn | Checked | Approved | Date     |
|----------|-------|---------|----------|----------|
| MW       | JP    | AM      | RR       | 28/01/20 |

Internal Project No. 60536736  
 Suitability S8  
 Scale @ A1 1:2500H/1:2500V  
 Zone Development Consent Order

THIS DOCUMENT HAS BEEN PREPARED PURSUANT TO AND SUBJECT TO THE TERMS OF AECOM'S APPOINTMENT BY ITS CLIENT. AECOM ACCEPTS NO LIABILITY FOR ANY USE OF THIS DOCUMENT OTHER THAN BY ITS ORIGINAL CLIENT OR FOLLOWING AECOM'S EXPRESS AGREEMENT TO SUCH USE, AND ONLY FOR THE PURPOSES FOR WHICH IT WAS PREPARED AND PROVIDED.

|                                   |                                     |                              |                               |                      |
|-----------------------------------|-------------------------------------|------------------------------|-------------------------------|----------------------|
| Drawing Number<br><b>HE514465</b> | Highways England PIN<br><b>-ACM</b> | I Originator<br><b>-DCO-</b> | I Volume<br><b>Z3 SW_PR_Z</b> | Rev<br><b>P03</b>    |
| Location<br><b>-DR-CH-1109</b>    |                                     |                              | I Type<br><b>I</b>            | I Number<br><b>I</b> |

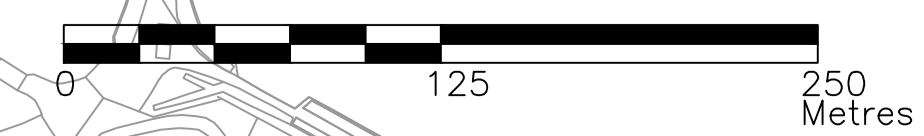



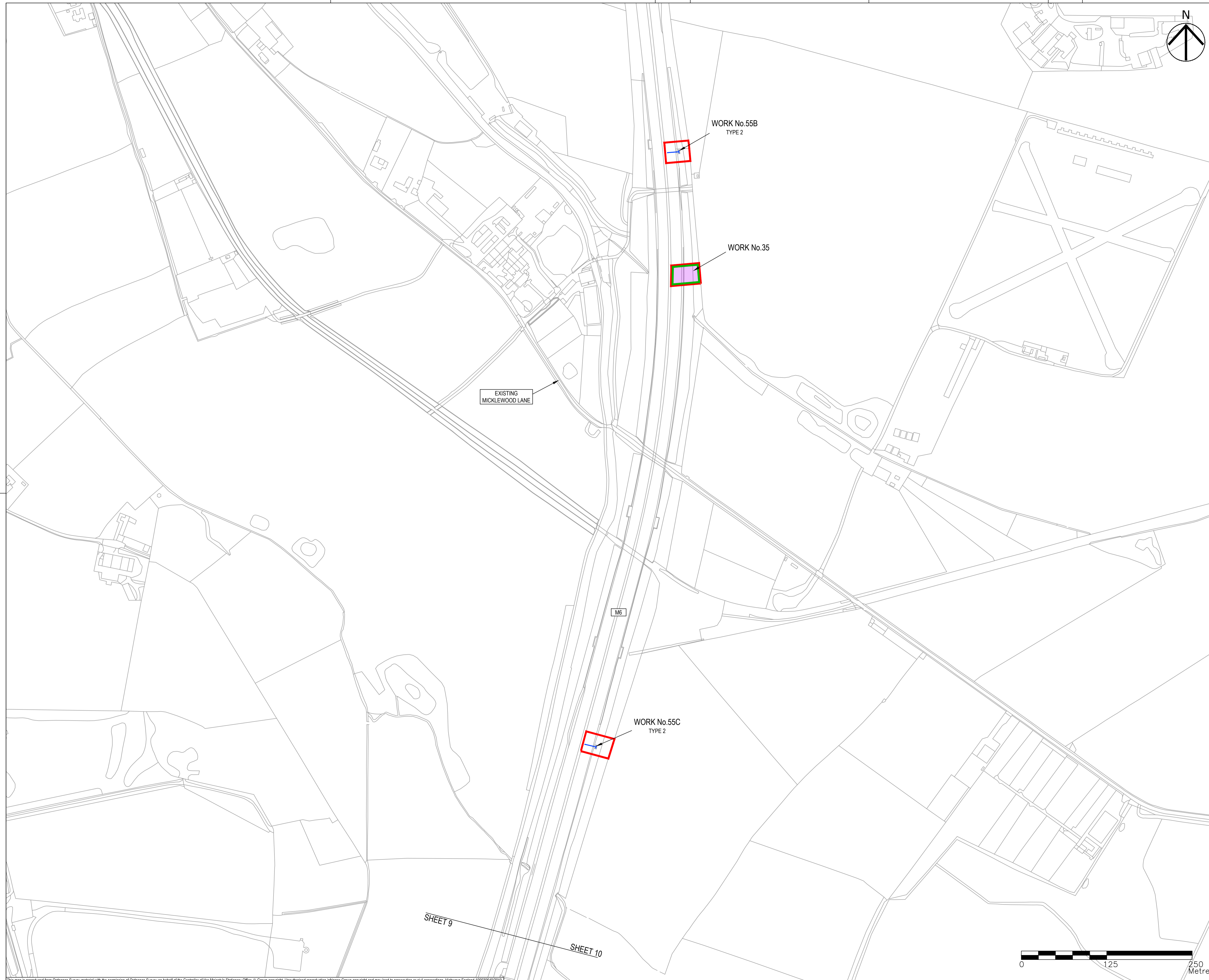

- NOTES**
- THIS DRAWING IS TO BE READ IN CONJUNCTION WITH ALL OTHER RELEVANT DOCUMENTATION.
  - DO NOT SCALE FROM THIS DRAWING, USE ONLY PRINTED DIMENSIONS.
  - ALL DIMENSIONS IN MILLIMETRES. ALL CHAINAGES, LEVELS AND COORDINATES ARE IN METRES UNLESS DEFINED OTHERWISE.
  - THIS DRAWING IS TO BE READ IN CONJUNCTION WITH THE PROJECT HEALTH & SAFETY FILE FOR ANY IDENTIFIED POTENTIAL RISKS.
  - THE WORKS ARE SHOWN ILLUSTRATIVELY ONLY AND ARE SUBJECT TO CHANGE THROUGH DETAILED DESIGN IN ACCORDANCE WITH THE TERMS OF THE DEVELOPMENT CONSENT ORDER.

- KEY**
- LIMITS OF LAND TO BE ACQUIRED OR USED PERMANENTLY OR TEMPORARILY (THE ORDER LIMITS)
  - LAND NOT INCLUDED WITHIN THE ORDER LIMITS
  - COMMENCEMENT OF LINEAR WORKS (APPROX.)
  - TERMINATION OF LINEAR WORKS (APPROX.)
  - HIGHWAY WORK CENTRELINE (APPROX.)
  - NON-LINEAR WORKS BOUNDARY
  - HIGHWAY WORK LIMIT OF DEVIATION
  - ENVIRONMENTAL MITIGATION AREA
  - SITE COMPOUND
  - BORROW PIT LIMITS OF DEVIATION
  - HIGHWAY DRAINAGE ATTENUATION POND
  - UTILITY DIVERSION CENTRELINE (APPROX.)
  - UTILITY DIVERSION LIMITS OF DEVIATION
  - PROPOSED GANTRY LIMIT OF DEVIATION
  - EXISTING GANTRY TO BE ALTERED
  - PROPOSED STRUCTURE
  - TYPE 1 ALTERATION OF PORTAL GANTRY
  - TYPE 2 ALTERATION OF CANTILEVER GANTRY
  - TYPE 3 NEW PORTAL GANTRY
  - TYPE 4 NEW CANTILEVER GANTRY

| Revision Details             | By | Check | Date     | Suffix |
|------------------------------|----|-------|----------|--------|
| First Issue                  | MW | RR    | 18/11/19 | P01    |
| DCO Submission               | JP | RR    | 06/12/19 | P02    |
| Works No.55 added.           | MW | RR    | 11/12/19 | P03    |
| DCO Submission Minor Changes | JP | RR    | 28/01/20 | P04    |

**Purpose of issue**  
DCO APPLICATION

**Client**  
Highways England  
Floor 5  
Two Colonnade Square  
38 Colonnade Circus  
Birmingham  
B4 6BN



**Development Consent Order Number**  
TR010054

**Project Title**  
M54 to M6 Link Road

**Development Consent Order Drawing Number**  
TR010054/APP/2.4

**Drawing Title**  
WORK PLANS  
REGULATION 5(2)(J)  
SHEET 10 OF 10

| Designed | Drawn | Checked | Approved | Date     |
|----------|-------|---------|----------|----------|
| MW       | JP    | AM      | RR       | 28/01/20 |

Internal Project No. 60536736  
Scale @ A1 1:2500H/1:2500V  
Suitability S8  
Zone Development Consent Order

THIS DOCUMENT HAS BEEN PREPARED PURSUANT TO AND SUBJECT TO THE TERMS OF AECOM'S APPOINTMENT BY ITS CLIENT. AECOM ACCEPTS NO LIABILITY FOR ANY USE OF THIS DOCUMENT OTHER THAN BY ITS ORIGINAL CLIENT OR FOLLOWING AECOM'S EXPRESS AGREEMENT TO SUCH USE, AND ONLY FOR THE PURPOSES FOR WHICH IT WAS PREPARED AND PROVIDED.

|                            |                              |                       |                         |            |
|----------------------------|------------------------------|-----------------------|-------------------------|------------|
| Drawing Number<br>HE514465 | Highways England PIN<br>-ACM | I Originator<br>-DCO- | I Volume<br>-DR-CH-1110 | Rev<br>P04 |
| Location<br>Z3 SW_PR_Z     | I Type<br>I Role             | I Number              |                         |            |